

Element de rigola fara panta prefabricata, L=1m

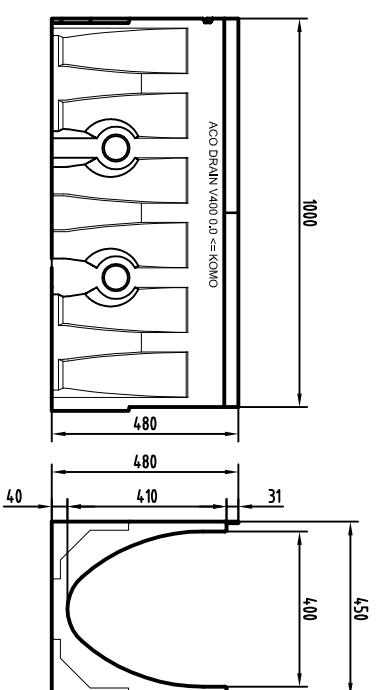

Tip	H (mm)	Mucie de protectie din:	
		Fonta	Art.-Nr.
Tip 0.0	480	12500	
Tip 0.1	480	12511	

Placa de capat amonte/aval

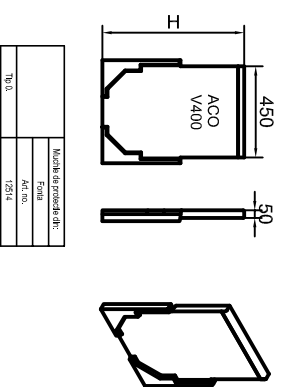

Mucie de protectie din:	
Fonta	
Art. nr.	12511
Tip	0.1

Element de rigola fara panta prefabricata, cu garnitura verticala de etansare DN400, L=1m

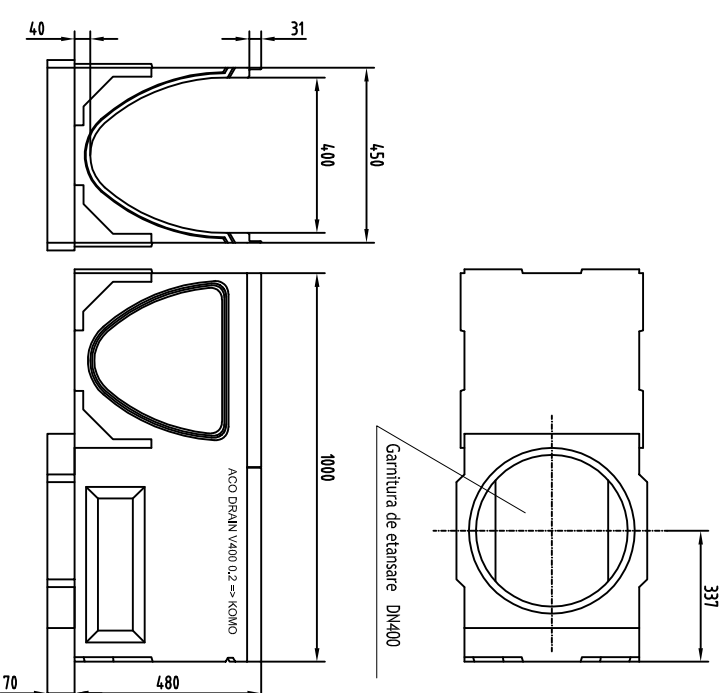

Tip	H (mm)	Mucie de protectie din:	
		Fonta	Art.-Nr.
Tip 0.2	550	12513	

Camion de descarcare, L=1m

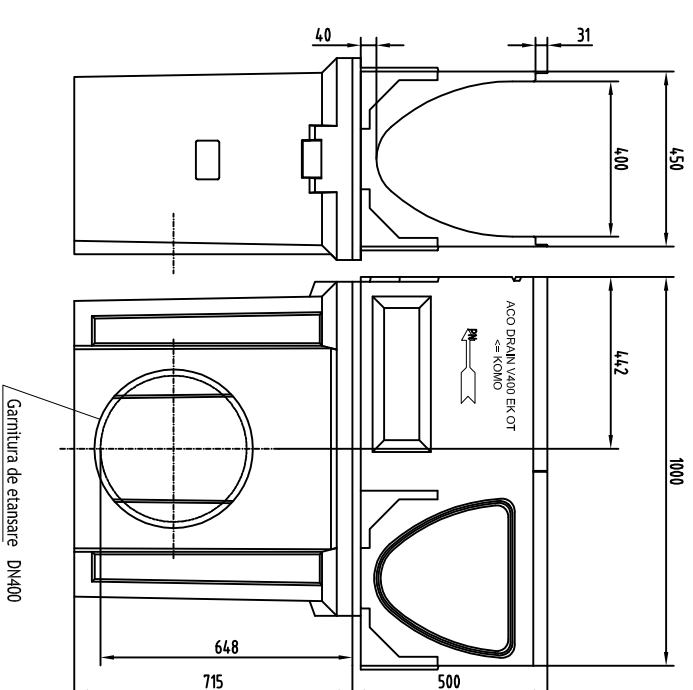

Tip	H (mm)	DN/OD	Mucie de protectie din:	
			Fonta	Art.-Nr.
Element superior	500		12512	
Element intermediar	330		10822	
Element inferior cu garnitura de etansare	715	315 / 400	10828 / 10823	

Numele sistemului: ACO DRAIN Multiline - V	Scara: 1:10	
Denumirea plansei: ACO DRAIN Multiline V400 G - clasa de sarcini DA400/E600	Data: 07/2017	
Nume fisier: Rigola V400V.dwg	Revizia nr.: 0	
Caracteristici tehnice Rigolele ACO DRAIN® Multiline V400 G sunt fabricate din beton cu polimeri, cu muchie de protectie din fonta, cu o sectiune de curgere in forma de "V", cu clasa de sarcini pana la E600 conform SR EN 1433	Desenat Adrian Pungodi	ACO srl Departamentul tehnic www.aco.ro tehnic@aco.ro