

ACO SlotTop 100, Inaltime fanta 150mm - C250/D400

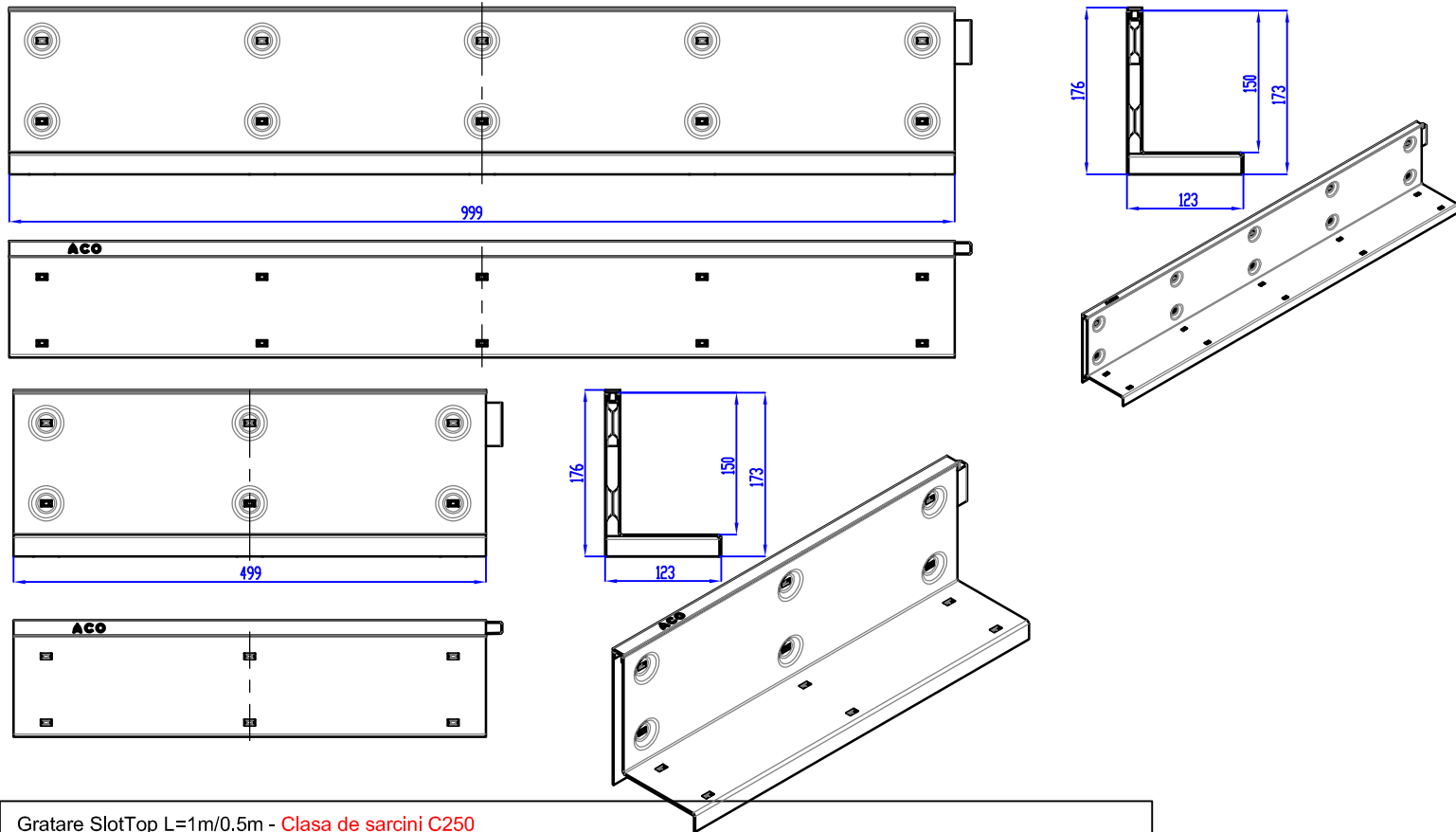

Gratare SlotTop L=1m/0.5m - Clasa de sarcini C250						
Material	Lungime de montaj [mm]	Latime de montaj [mm]	Inaltimea fantei [mm]	Deschidere [mm]	Suprafata de intrare [cmp/m]	Cod
Otel zincat	1000	123	150	10	100	445932
	500	123	150	10	100	445933
Inox	1000	123	150	10	100	445934
	500	123	150	10	100	445935

Gratare SlotTop L=1m/0.5m - Clasa de sarcini D400						
Material	Lungime de montaj [mm]	Latime de montaj [mm]	Inaltimea fantei [mm]	Deschidere [mm]	Suprafata de intrare [cmp/m]	Cod
Otel zincat	1000	123	150	10	100	446021
	500	123	150	10	100	446022
Inox	1000	123	150	10	100	446024
	500	123	150	10	100	446025

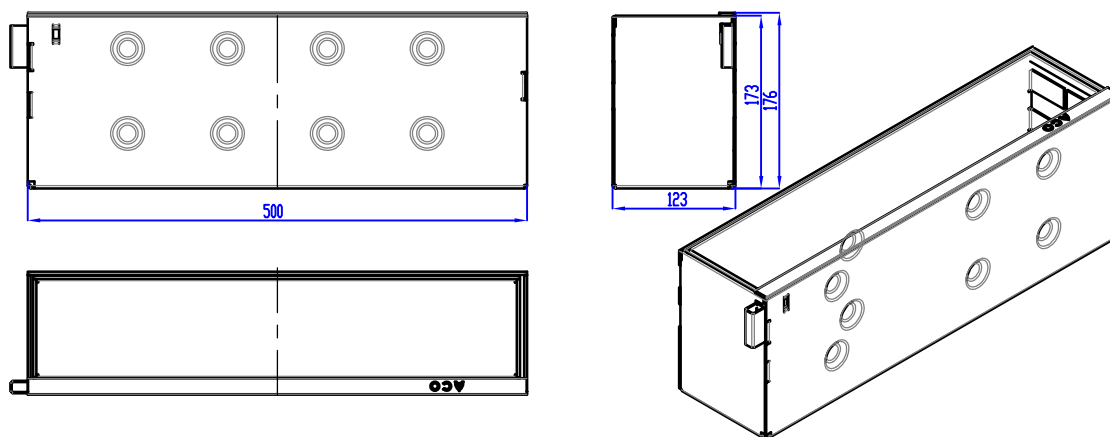

Element de revizie - Clasa de sarcini C250						
Material	Lungime de montaj [mm]	Latime de montaj [mm]	Inaltimea fantei [mm]	Deschidere [mm]	Suprafata de intrare [cmp/m]	Cod
Otel zincat	500	123	150	10	100	445937
Inox	500	123	150	10	100	445936

Element de revizie - Clasa de sarcini D400						
Material	Lungime de montaj [mm]	Latime de montaj [mm]	Inaltimea fantei [mm]	Deschidere [mm]	Suprafata de intrare [cmp/m]	Cod
Otel zincat	500	123	150	10	100	446023
Inox	500	123	150	10	100	446026

Numele sistemului: ACO SlotTop 100	Scara: 1:10	
Denumirea plansei: ACO SlotTop 100 - clasa de sarcini C250/D400	Data: 03/2019	
Nume fisier: SlotTop 100.dwg	Revizia nr. 0	
Caracteristici tehnice Gratare tip fanta cf. SR EN 1433, cu fanta laterala, placi de ghidare, margine superioara armate, profil de protectie fanta inclus, material otel galvanizat sau otel inoxidabil, compatibile cu rigolele ACO Drain Multiline Seal in V100 si XtraDrain X100	Desenat Adrian Pungoci	
		<p style="text-align: center;">ACO srl</p> <p>Departamentul tehnic</p> <p>www.aco.ro tehnic@aco.ro</p>